

# Reflection Gallery

## About the Gallery

### About the Gallery

Reflection Gallery, located in the NUSU Student Centre, is supported and operated by the Nipissing University Student Union (NUSU), and provides exhibition space to support and celebrate the diverse artistic, cultural, and creative works produced by Nipissing students and alumni. In addition to the main gallery, we program temporary exhibitions throughout and around the NUSU Student Centre. The gallery functions as a social hub for the university community and as a bridge connecting the university to our broader local and regional communities.

Reflection Gallery's mandate is:

- To exhibit and celebrate the artistic, cultural, and creative works of Nipissing students and alumni.
- To strengthen connections between Nipissing students and alumni.
- To provide Nipissing students with experiential learning and professional development opportunities through direct participation in the gallery's programming and operation.
- To enrich the artistic, cultural, social, educational, and intellectual experience of all Nipissing students and other members of the Nipissing University community.
- To connect the university community with our broader local and regional communities.
- To promote the work of Nipissing students to the broader public.
- To value and promote inclusivity, accessibility, and diversity.
- To promote and reflect the core values of Nipissing University and the Nipissing University Student Union

### Gallery Programming and Operations

The Exhibition Programming and Operations Committee is responsible for overseeing the programming and operation of Reflection Gallery, the Study Nooks Hallway, Main Entrance Foyer, and other temporary exhibition spaces within and around the NUSU Student Centre. The committee is comprised of representatives from NUSU, Nipissing faculty, staff, and students, and reports to the NUSU Executive Committee.

Students play a vital role in the gallery's programming and operation through direct participation in programming selection, assisting with installation and deinstallation of exhibitions, documentation, marketing, and promotion. Student volunteers work closely with members of

the Exhibition Programming and Operations Committee to fulfill all aspects of the gallery's mandate.

Exhibition proposals/submissions are initially reviewed and shortlisted by student volunteers under the guidance of members of the Exhibition Programming and Operations Committee. Shortlisted submissions are then presented to the Exhibition Programming and Operations Committee for final selection and approval.

Reflection Gallery, the Study Nook Hallway, and the Main Entrance Foyer are scheduled in three programming blocks per year, as follows:

<b>Fall Exhibition Program</b> (September 1 <sup>st</sup> to December 31 <sup>st</sup> )	<b>Submission Deadline is May 31<sup>st</sup></b>
<b>Winter Exhibition Program</b> (January 1 <sup>st</sup> to April 30 <sup>th</sup> )	<b>Submission Deadline is September 30<sup>th</sup></b>
<b>Spring/Summer Exhibition Program</b> (May 1 <sup>st</sup> to August 30 <sup>th</sup> )	<b>Submission deadline is January 31<sup>st</sup></b>

An opening reception is usually arranged for each exhibition held in Reflection Gallery and typically occurs on Fridays, between 6-8pm. Actual days/times may vary depending upon the exhibition.

The Main Entrance Foyer is licenced for food and drink and can be used for exhibition receptions. NUSU and the Exhibition Programming and Operations Committee are happy to arrange food and drink service for receptions upon request. Standing tables are also available.

Artist(s)/exhibitor(s) are responsible for all costs related to the production of artwork, transportation of artwork to and from the gallery, exhibition specific signage, wall labels, and promotional materials.

NUSU provides selected artist(s)/exhibitor(s) with exhibition space at no charge. The Exhibition Programming and Operations Committee supports marketing and promotion efforts through our social media channels and can try to arrange student volunteers to assist with the mounting of exhibitions.

## NUSU Opportunities Fund

NUSU has established an Opportunities Fund to assist Nipissing students with some of their exhibition costs. Only current Nipissing students are eligible to apply. Expenses eligible for reimbursement include transportation of artwork, signage, wall labels, marketing, and promotion. Students selected for an exhibition can submit a request for funding by contacting [exhibitions@nusu.com](mailto:exhibitions@nusu.com). Please put “Opportunities Fund” in the subject line. Receipts are required for any/all reimbursement. The NUSU Executive is responsible for determining eligibility and the amount of reimbursement provided.

## How to Get Involved

Nipissing faculty, staff, and students who would like to volunteer and support Reflection Gallery’s operations are invited to express their interest in writing by contacting [exhibitions@nusu.com](mailto:exhibitions@nusu.com).

## Exhibition Submissions

We welcome submissions from all members of the university, including students, alumni, staff, faculty, and administration. Applicants are welcome to submit proposals for solo, two-person, or group exhibitions, as well as collaborative exhibitions with local or regional artists or organizations that seek to enrich the artistic, cultural, social, educational and/or intellectual life of the university. In addition to our regular exhibition programming, we occasionally host special workshops and events.

We aim to develop a balanced and diverse exhibition program. We encourage submissions from all members of the university, including underrepresented and/or equity-seeking members such as, but not limited to, women, indigenous persons, persons of colour, persons with disabilities, and persons of all sexual orientations and gender identities.

We are committed to equity and inclusion in all aspects of our operation. While we have established specific submission criteria, we are open to receiving submissions in alternate formats if it eliminates barriers to participation. Feel free to contact us to discuss your submission needs.

The Reflection Gallery Exhibition Submission Form contains all submission details and requirements and can be found at [nusu.com/gallery](http://nusu.com/gallery).

## Contact Information

Inquiries regarding the exhibition spaces, exhibition proposals/submissions, schedules and events can be sent to [exhibitions@nusu.com](mailto:exhibitions@nusu.com).

### Gallery Location

NUSU Student Centre  
Room 101  
221 College Drive  
North Bay, On  
Canada  
P1B 8L7

### Gallery Hours

Monday to Friday, 8:30am-4:30pm  
Closed on weekends and holidays

## More About Reflection Gallery's Exhibition and Project Spaces

The Exhibition Programming and Operations Committee oversees various spaces throughout and around the NUSU Student Centre. Our main exhibition space is the Reflection Gallery, located in room 101. We also strive to activate/program the Study Nooks Hallway and Main Entrance Foyer with a frequent rotation of artwork.

Below are floorplans of some of our exhibition spaces. All measurements are approximate.

The red ovals indicate the location of our main exhibition spaces:

# THE NEW STUDENT CENTRE

MAIN FLOOR PLAN

Reflection Gallery

Main Entrance Foyer

Study Nooks Hallway

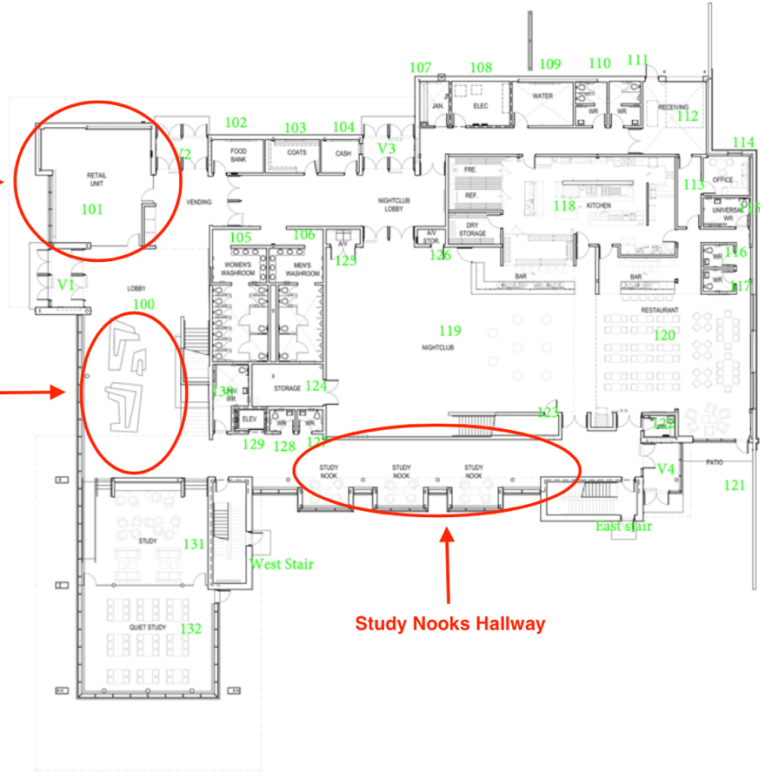

**NUSU**  
MITCHELL  
JENSEN  
ARCHITECTS

Floorplan of Reflection Gallery, room 101:

